

Airgle APP連接教學 (自動模式)

- Airgle APP 內的自動模式可以指定模式/風速/於指定時間開關
- 例子:逢星期一至五於 09:30開機，3風速，於18:00關機

Automation mode(開機&指定模式)

1. 於Automation 界面,
按右上角的+號

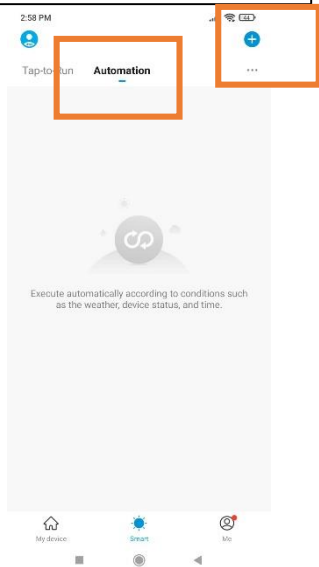

2. 按Schedule 設定時間

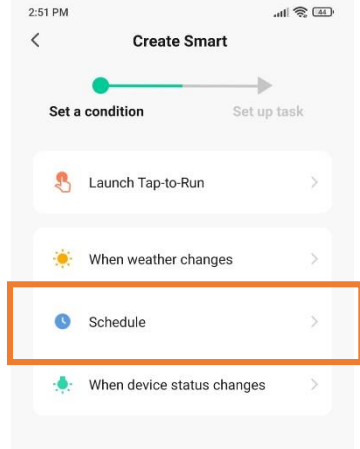

3. 設定開機時間，後
按repeat 設定日子

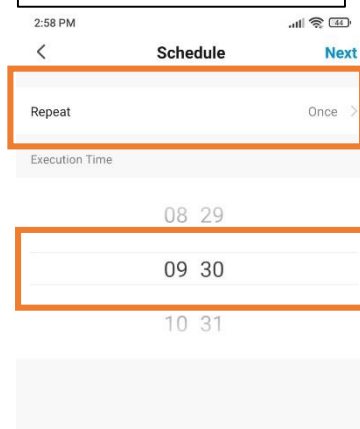

4. 按repeat 設定日子

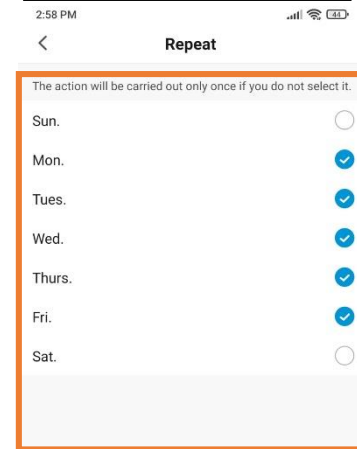

5. 按Run the device

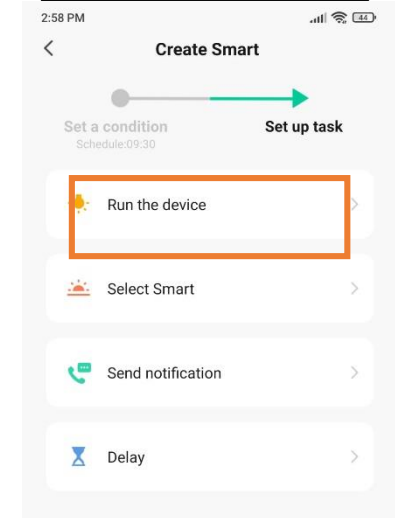

6. 選擇相關的型號

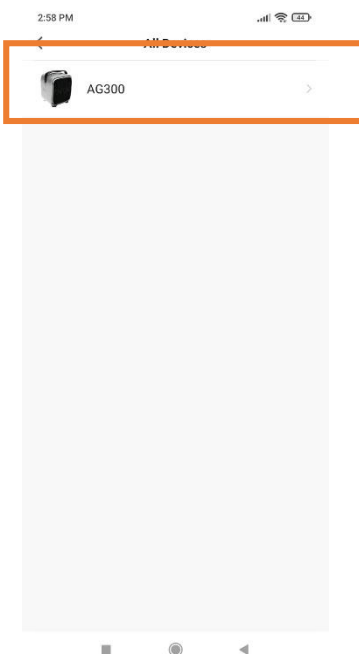

7. 點擊相關指令

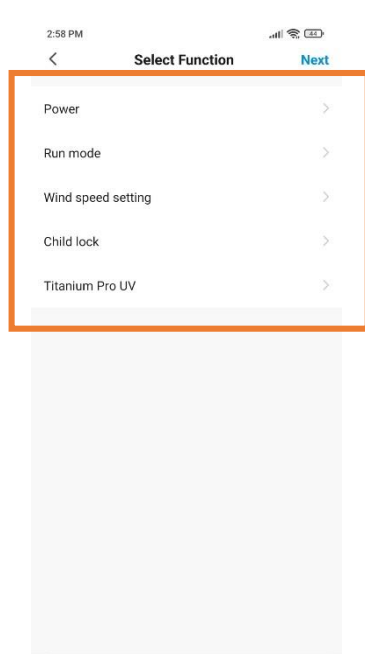

=> 開機/關機

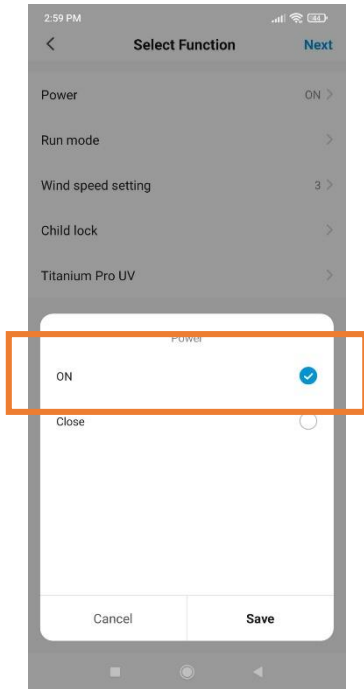

=> 風速

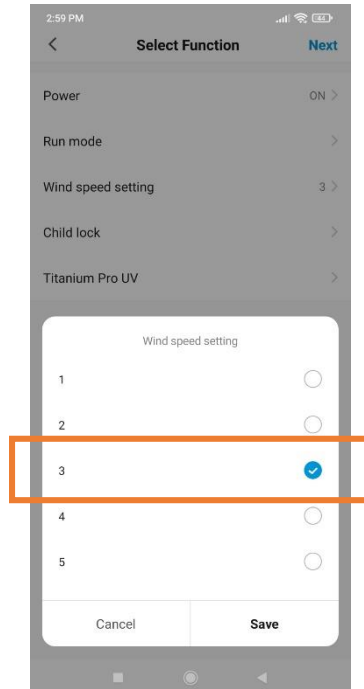

=> 模式

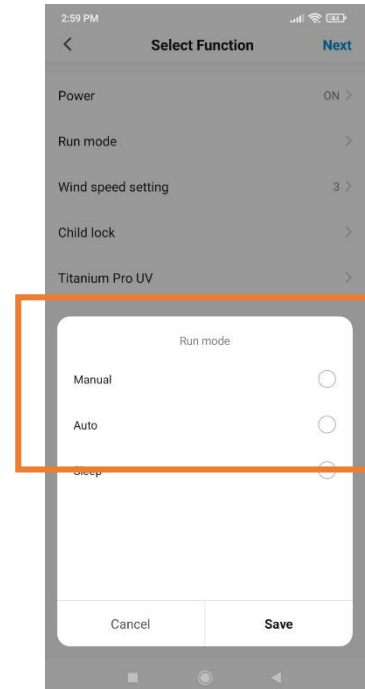

8. Automation mode(開機) 完成

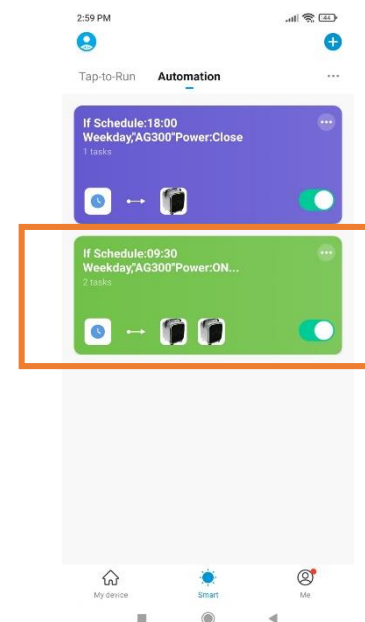

Automation mode(關機)

1. 於Automation 界面, 按右上角的+號

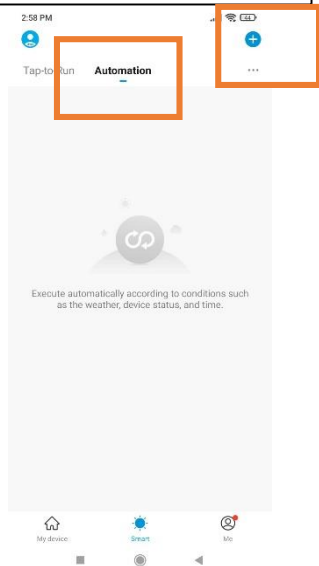

2. 按Schedule 設定時間

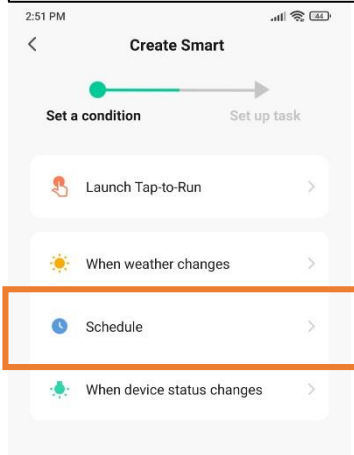

3. 設定關機時間, 後按repeat 設定日子

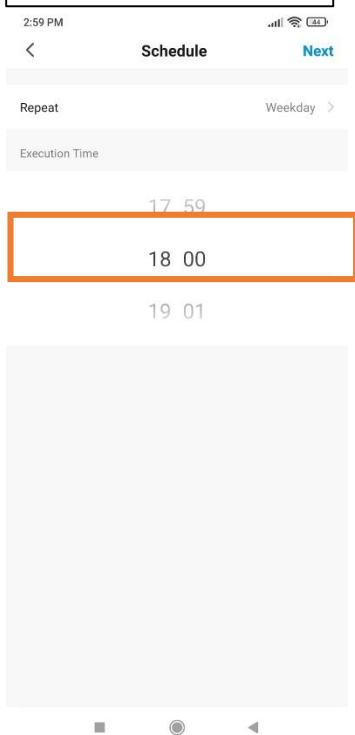

4. 按repeat 設定日子

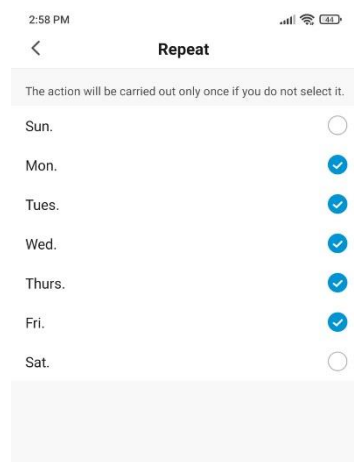

5. 點擊相關指令 => 關機

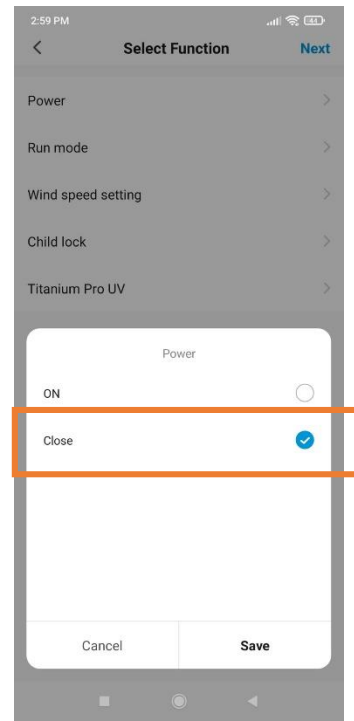

Automation mode (關機) 完成

